

PLAN SCALE 1:10

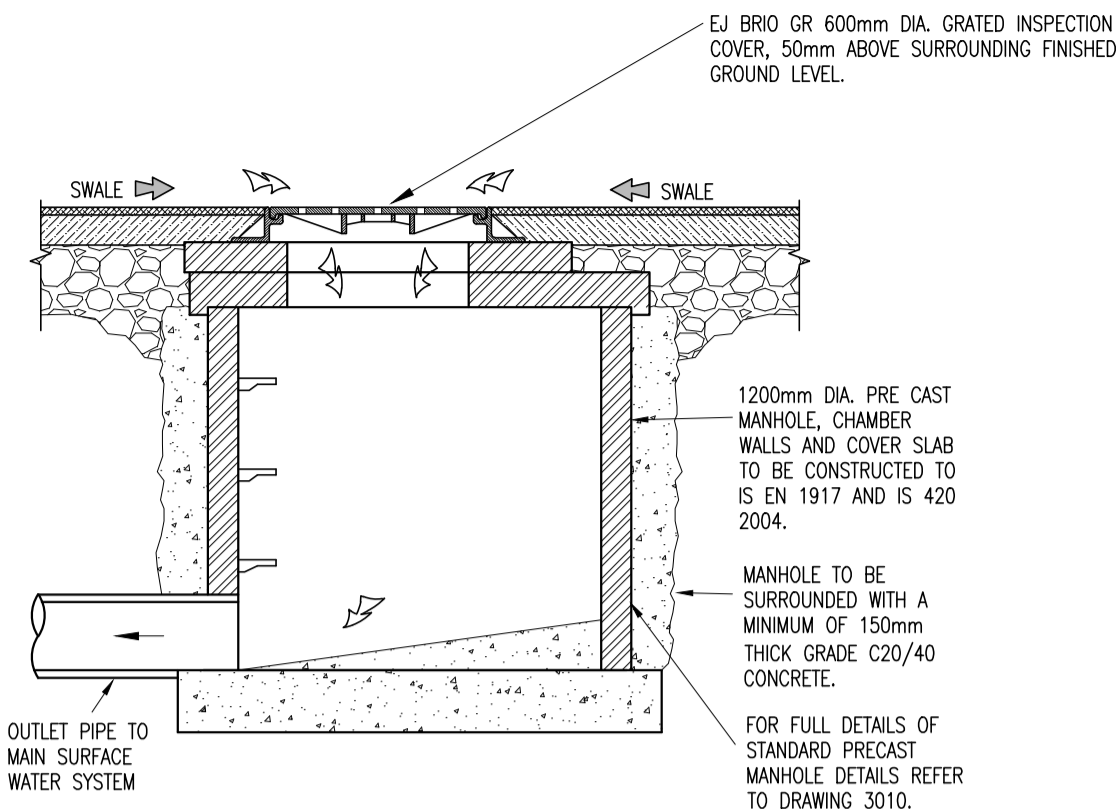

CROSS-SECTION SCALE: N.T.S.

GRATED MANHOLE INLET CHAMBER [FOR ROAD DRAINAGE]

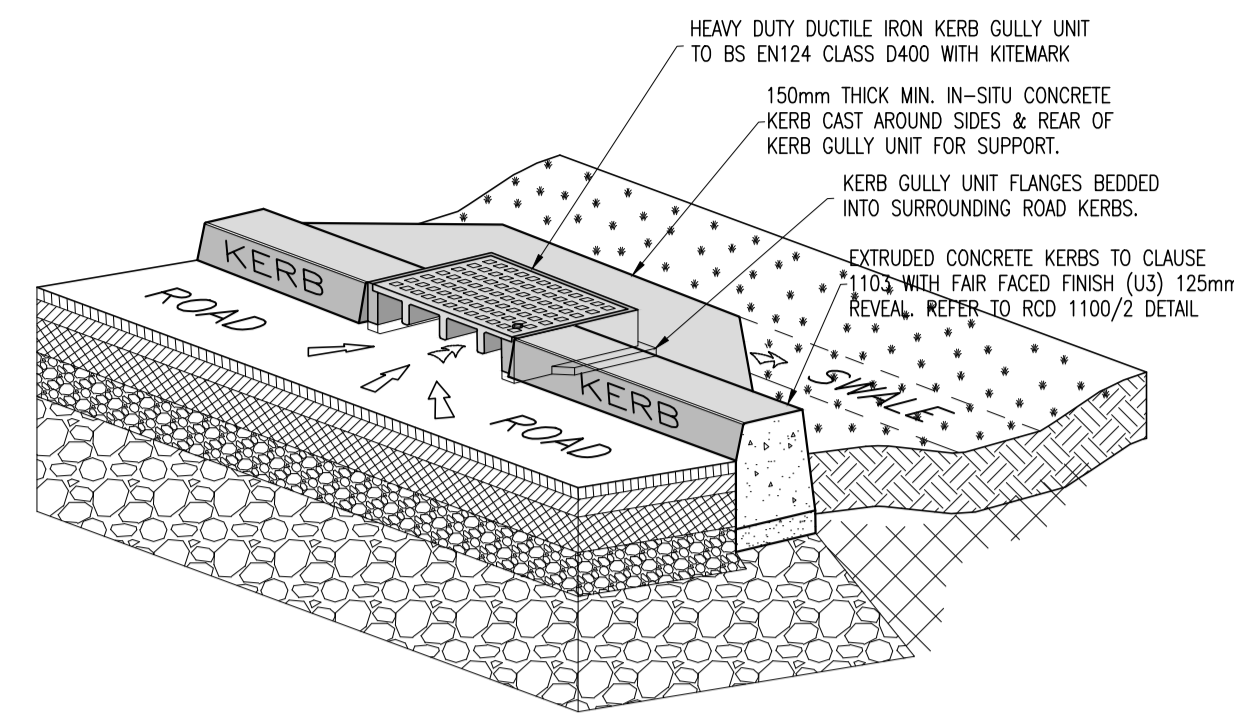

LATERAL INLET KERB GULLY SCHEMATIC [FOR ROAD DRAINAGE] SCALE: N.T.S.

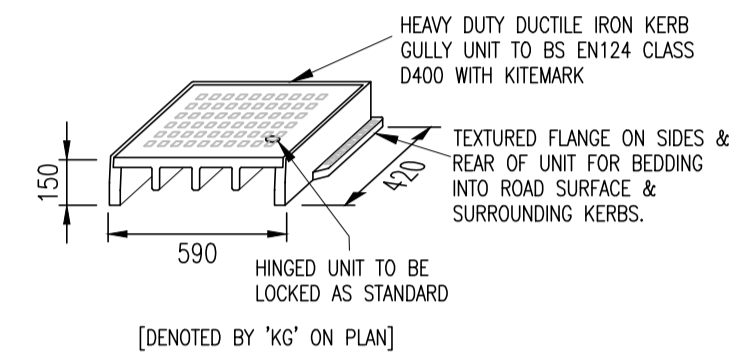

LATERAL INLET KERB GULLY DETAIL [LOCATED ALONG KERBLINES TO ALLOW ROAD SURFACE WATER RUN-OFF INTO SWALES] SCALE: N.T.S.

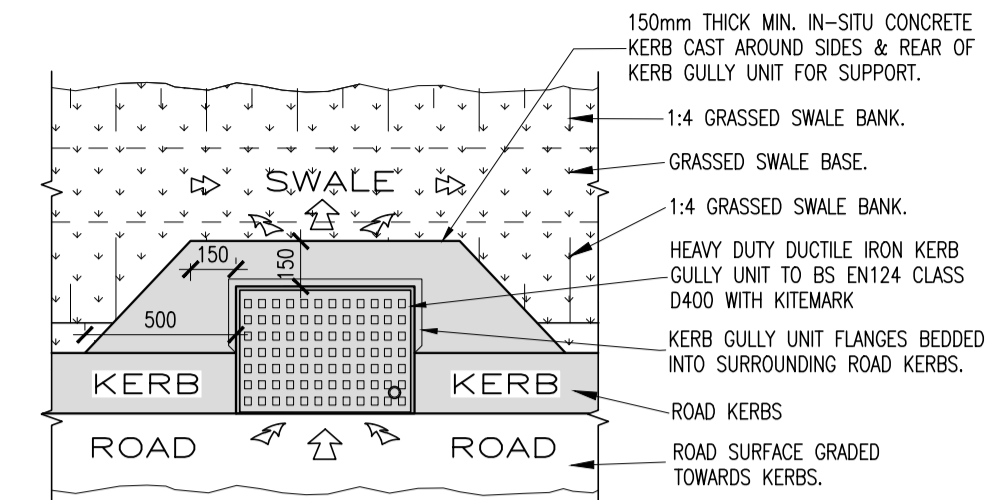

LATERAL INLET KERB GULLY PLAN [FOR ROAD DRAINAGE] SCALE: N.T.S.

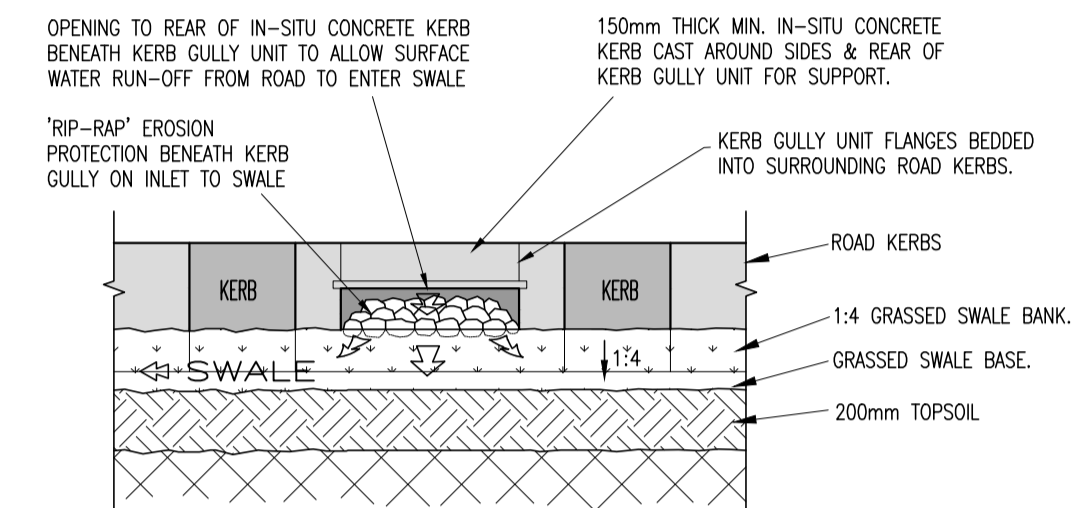

LATERAL INLET KERB GULLY - REAR ELEVATION [FOR ROAD DRAINAGE] SCALE: N.T.S.

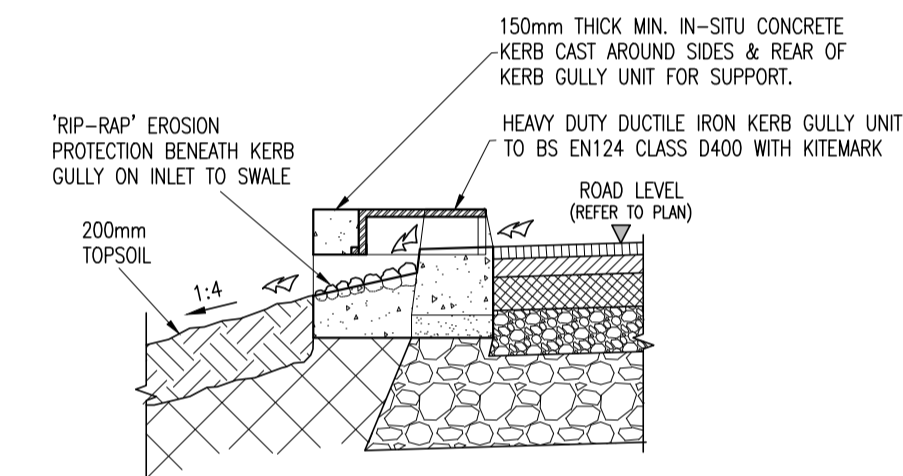

LATERAL INLET KERB GULLY TO SWALE CROSS-SECTION [FOR ROAD DRAINAGE] SCALE: N.T.S.

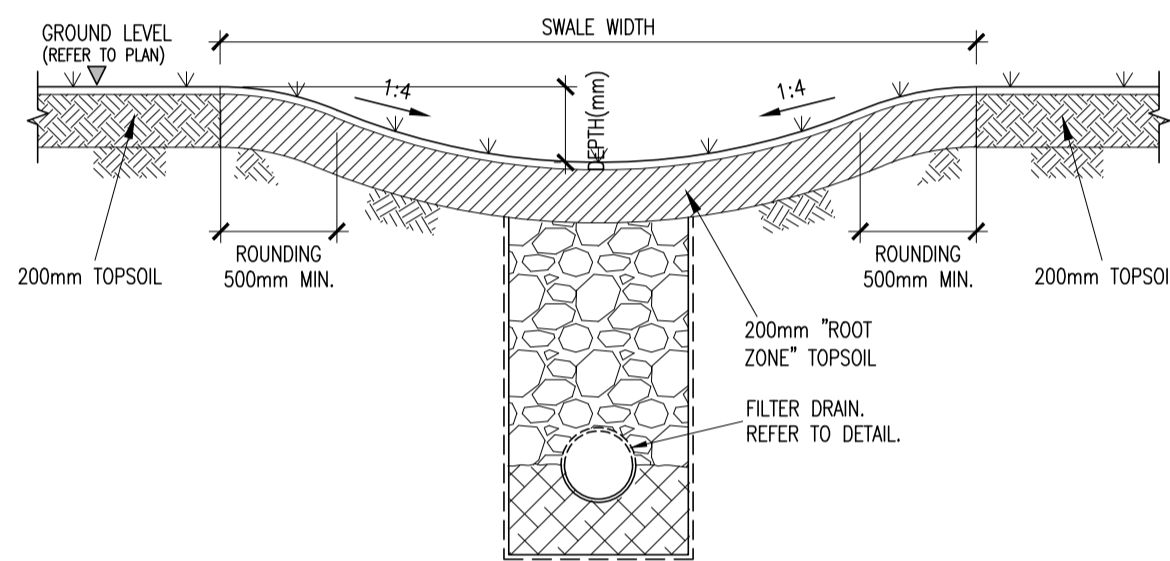

DRY SWALE DETAIL SCALE: N.T.S.

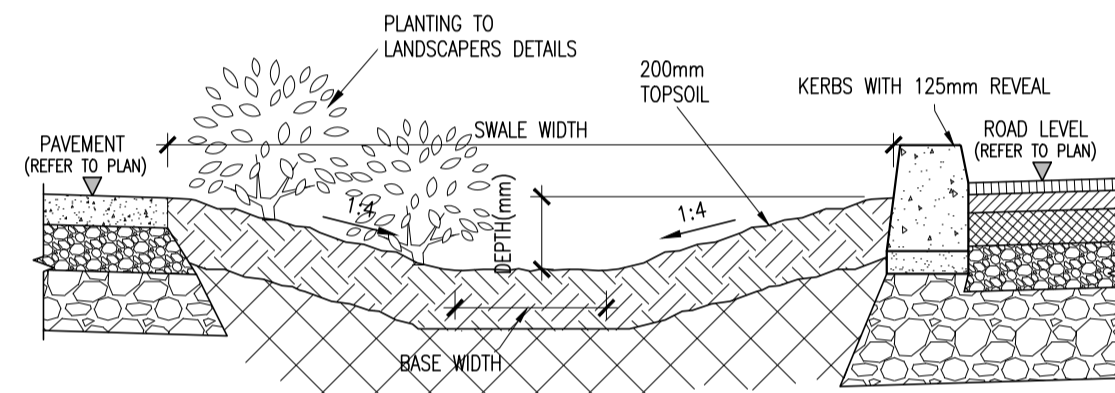

'WET' SWALE CROSS-SECTION [FOR ROAD DRAINAGE] SCALE: N.T.S.

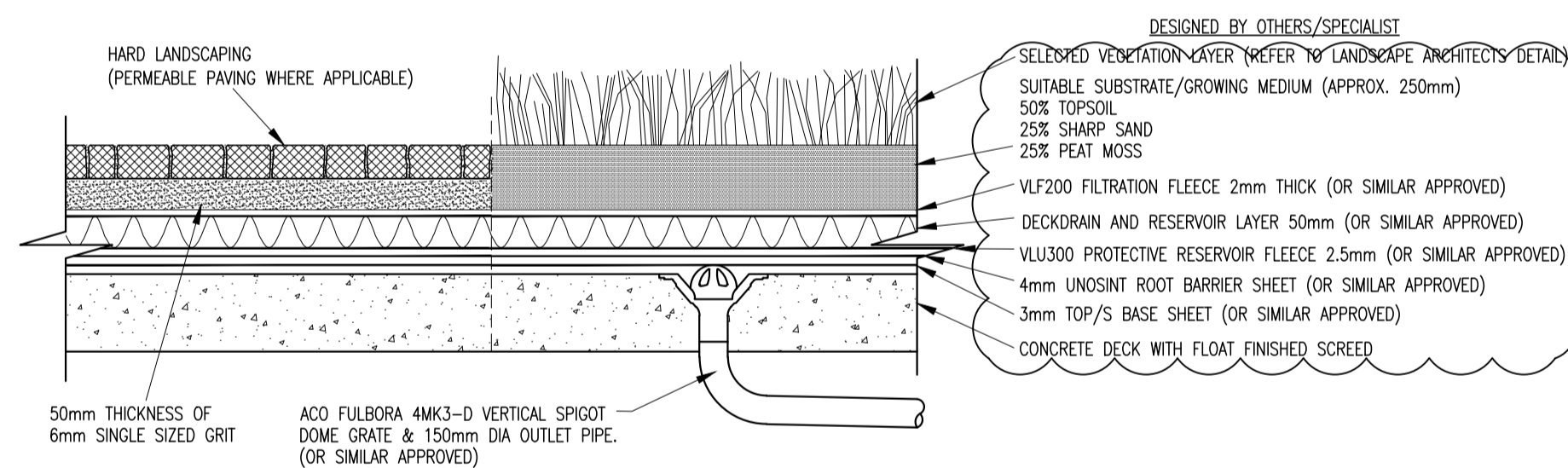

TYPICAL INTENSIVE GREEN ROOF WITH OUTLET DETAIL SCALE: N.T.S.

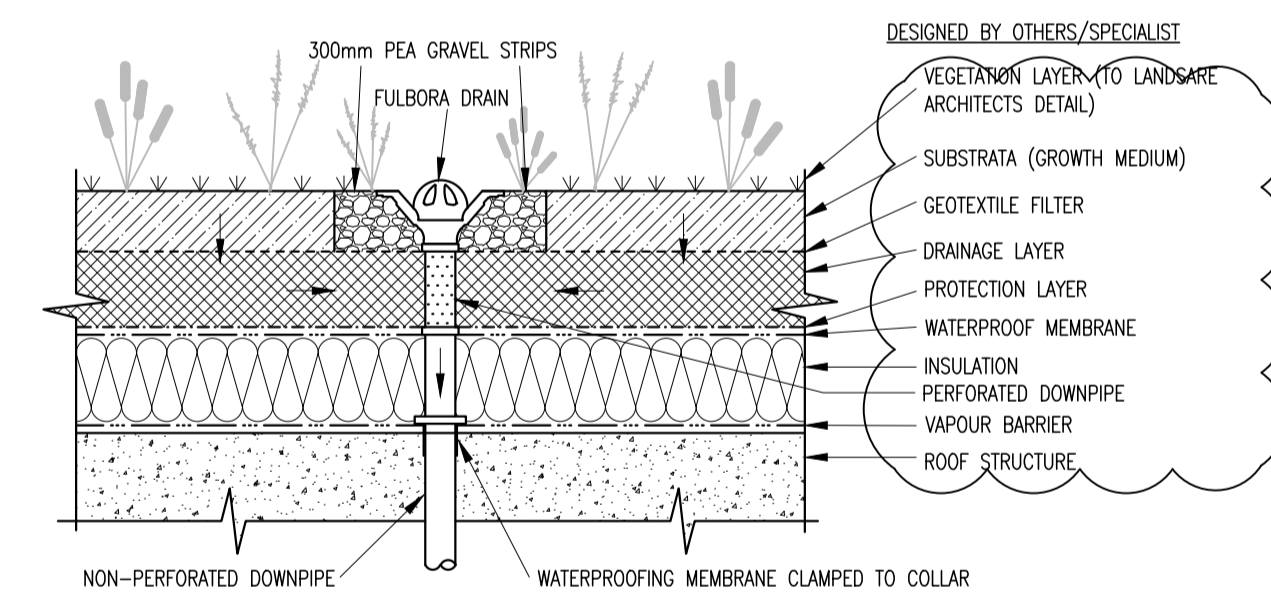

TYPICAL EXTENSIVE GREEN ROOF WITH OUTLET DETAIL

© COPYRIGHT OF THIS DRAWING IS RESERVED BY DBFL CONSULTING ENGINEERS. NO PART SHALL BE REPRODUCED OR TRANSMITTED WITHOUT THEIR WRITTEN PERMISSION.

NO CHANGES OF WHATSOEVER NATURE ARE TO BE MADE TO ANY DETAILS SET OUT OR CONTAINED IN ANY DBFL SPECIFICATIONS OR DRAWINGS UNLESS THE EXPRESS CONSENT HAS BEEN OBTAINED IN ADVANCE, IN WRITING, FROM DBFL.

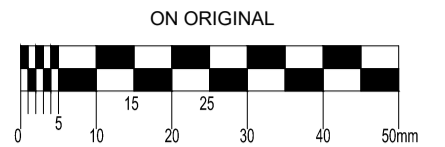

NOTES:

P01	30-03-22	ISSUED FOR PLANNING	KGO	PM
rev	date	description	by	chkd.
		A - Approved		
		B - Approved with comments		
		C - Do not use		

suitability	issue purpose
S2 - INFORMATION	PLANNING

DBFL Consulting Engineers
Civil, Structural & Transportation Engineering
www.dbfl.ie

DUBLIN OFFICE: Ormond House, Upper Ormond Quay, Dublin 7, D07 W0T4
PHONE: +353 1 401 4000

CORK OFFICE: 14 South Mall, Cork, T12 CT91
PHONE: +353 21 2024538

WATERFORD OFFICE: Suite 10 The Atrium, Maritime Gate, Canada Street, Waterford, X91 WC08
PHONE: +353 51 309 500

project ref:
DE LA SALLE RESIDENTIAL DEVELOPMENT BALLYFERMOT, DUBLIN 10

drawing title:
STANDARD SUDS DETAILS SHEET 2 OF 3

architect:
DELPHI ARCHITECTS

designed by	author	scale	sheet size
PM	KGO	AS SHOWN	A1
drawing no.		revision	
180189-DBFL-XX-X-DR-C-5008		P01	