

(C)
 This Model and any design herein is the copyright of the DBFL and must not be reproduced without their written consent. All drawings remain the property of the Consultants.
 Figured dimension only to be taken from this drawing. All dimensions to be checked on site. Consultants to be informed immediately of any discrepancies before work proceeds.

FOUNDATION SCHEDULE	
REF	DESCRIPTION
P01	4500x4500x1000dp RC PAD
P02	3500x3500x800 RC PAD
P03	3000x3000x700 RC PAD
SF1	1500x800 Dp RC STRIP FOOTING

FOUNDATION SCHEDULE	
REF	DESCRIPTION
SF2	1800x800 Dp RC STRIP FOOTING
SF3	2000x800 Dp RC STRIP FOOTING

COLUMN SCHEDULE	
REF	DESCRIPTION
C01	300x900 RC COLUMN

NOTE:
 SIZING/POSITIONING OF STRUCTURAL ELEMENT SHOWN, INCLUDING FOUNDATIONS, ARE PRELIMINARY ONLY AND ARE SUBJECT TO CHANGE BASED ON FURTHER GEOTECHNICAL IN-SITU TESTING AND AT DETAILED DESIGN PHASE

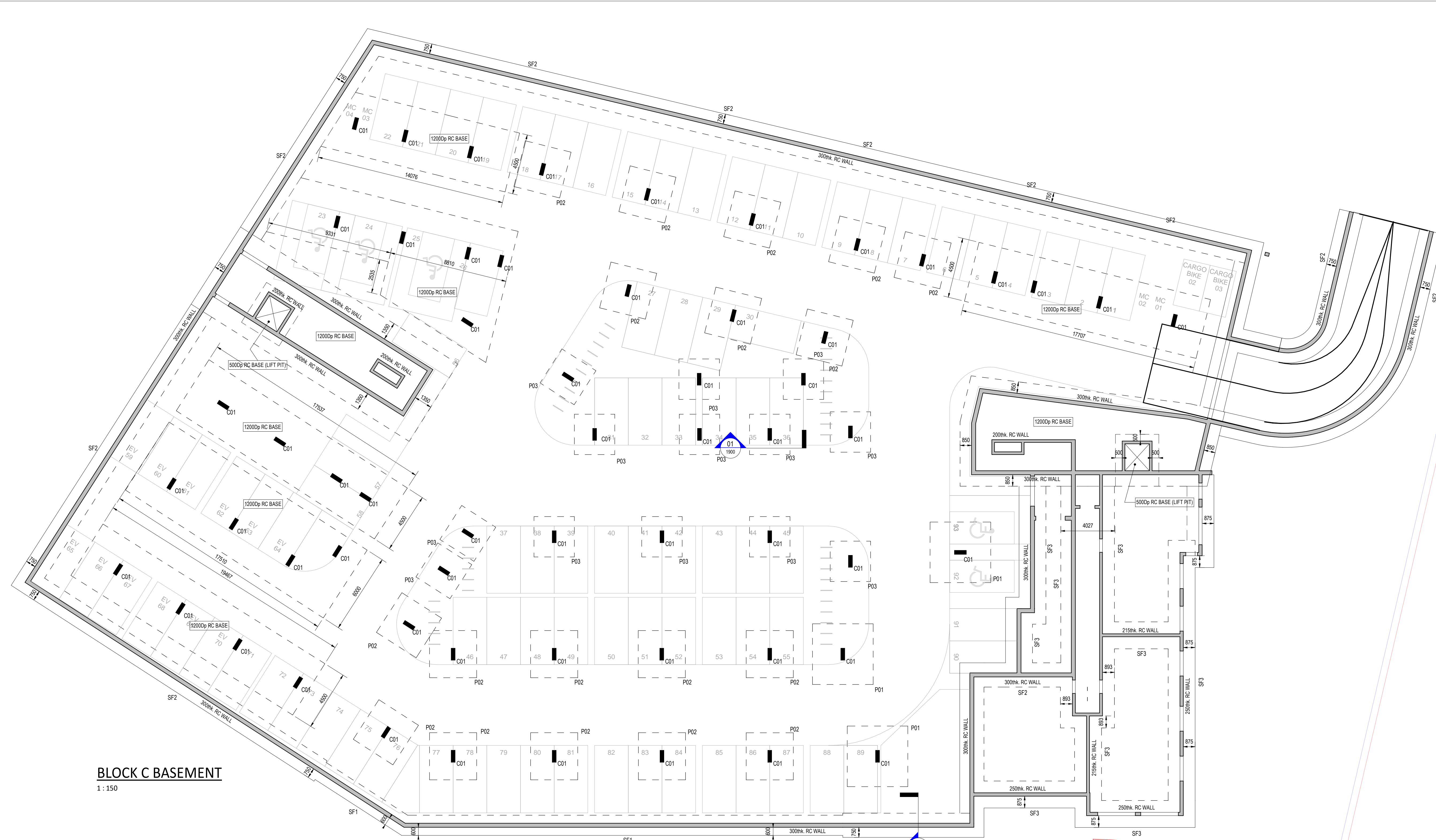

BLOCK C BASEMENT
 1 : 150

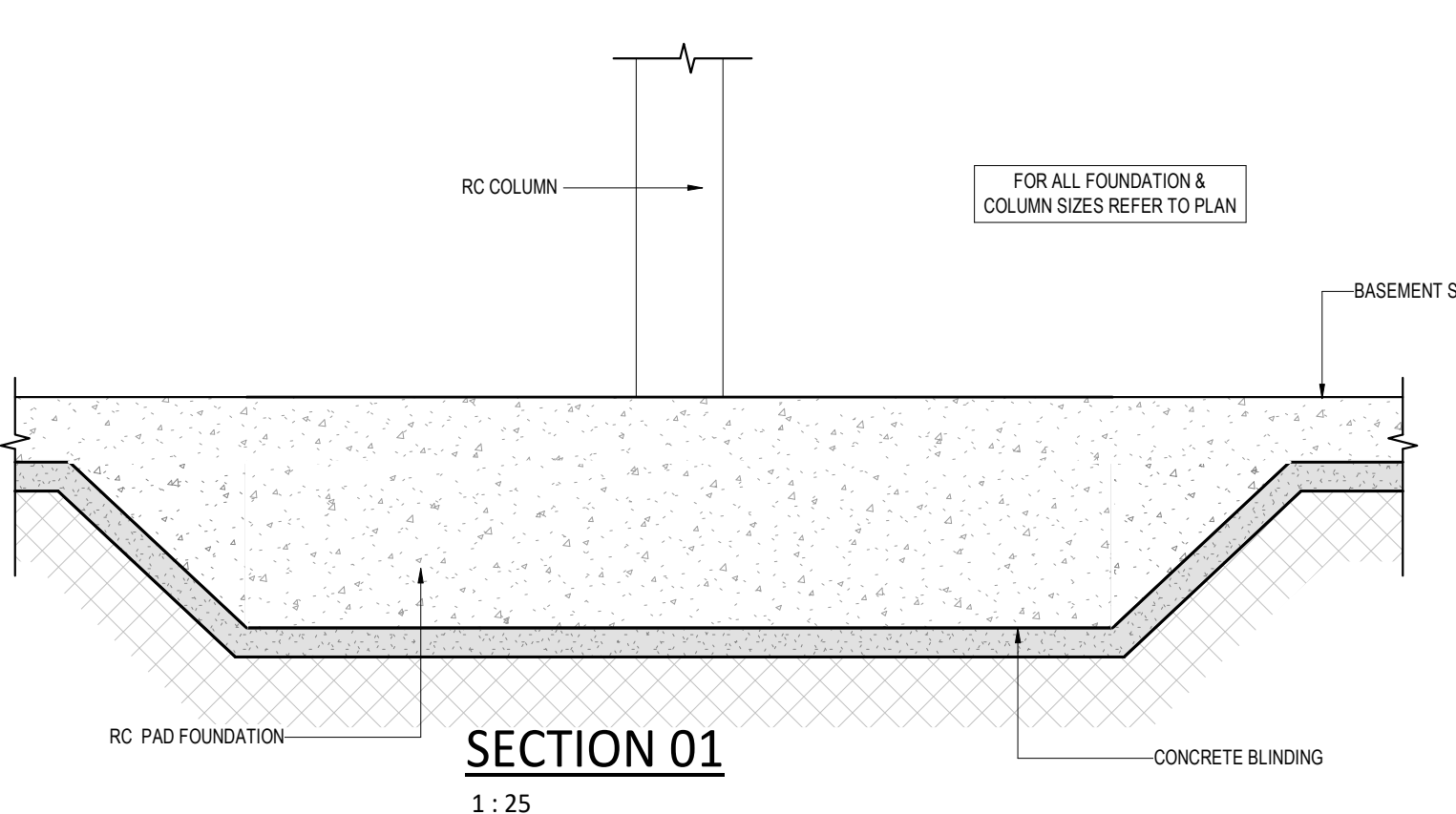

SECTION 01
 1 : 25

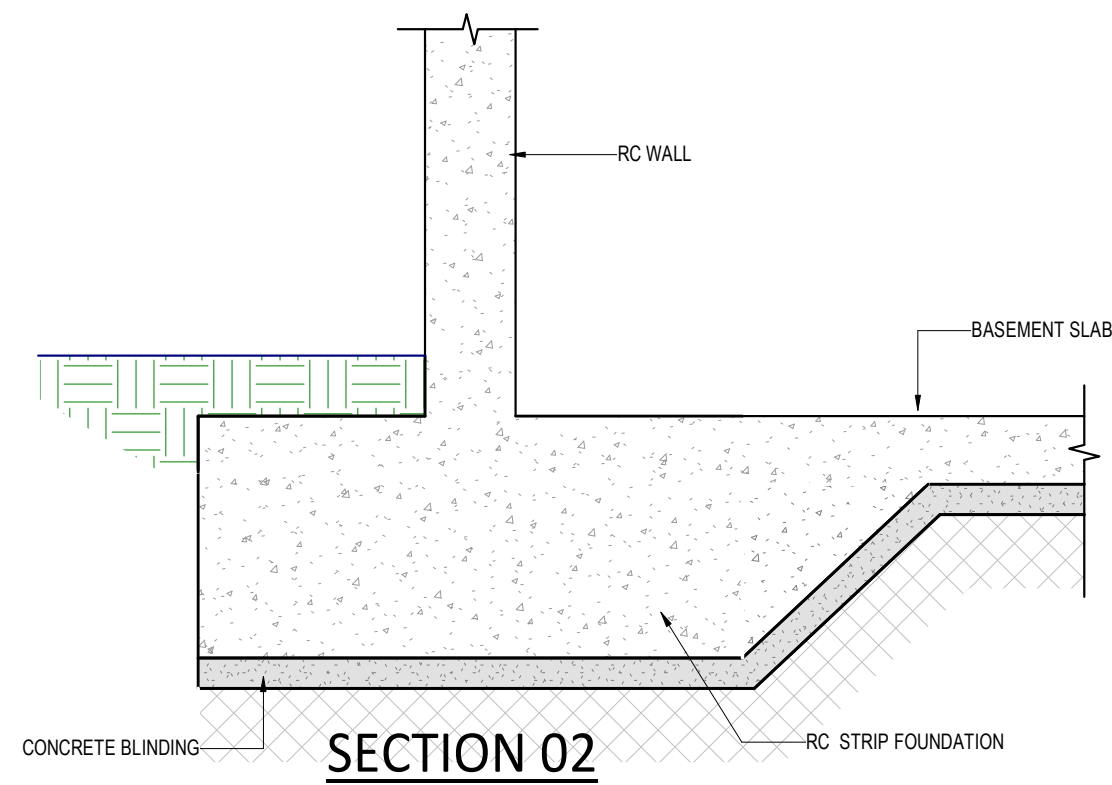

SECTION 02
 1 : 25

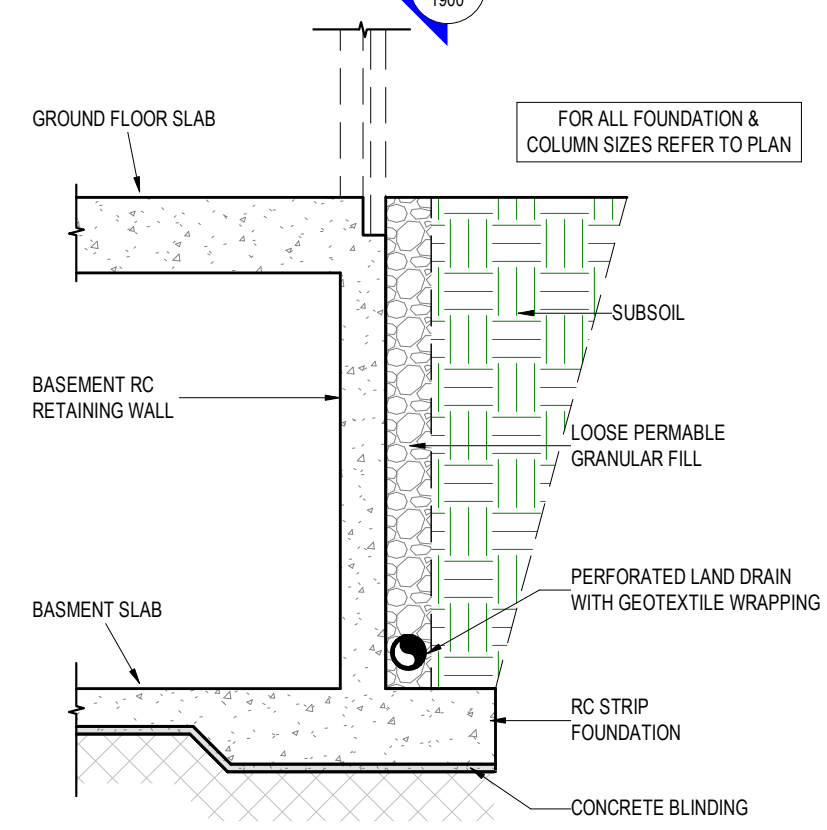

TYP. BASEMENT SECTION
 1 : 50

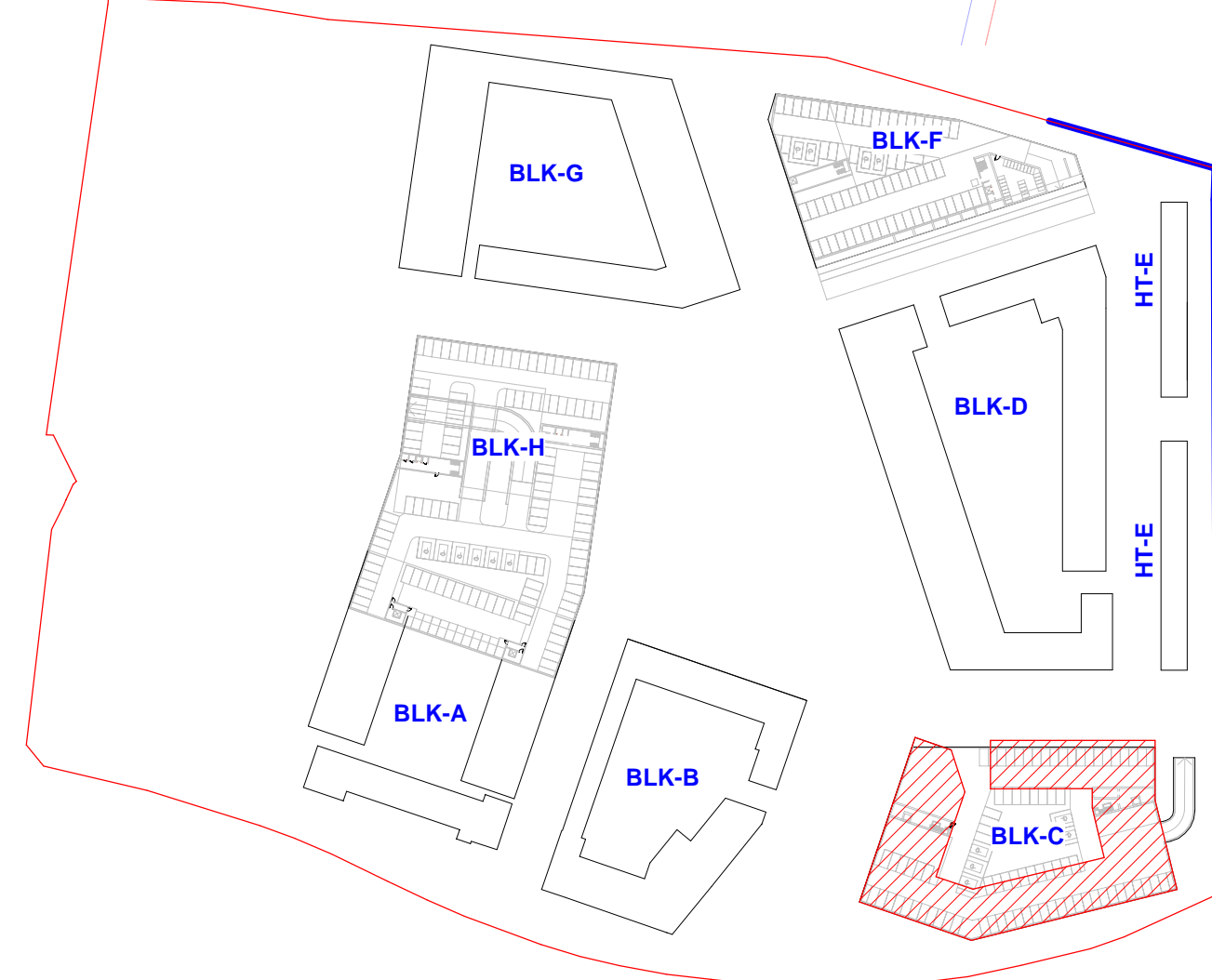

REV	date	description	DMS	CD
P01	07-04-22	ISSUED FOR PLANNING		

client approval	A - Approved	by	chkd.
	B - Approved with comments		
	C - Do not use		

suitability S1 - SUITABLE FOR CO-ORDINATION issue purpose PLANNING

DBFL Consulting Engineers
 Civil, Structural & Transportation Engineering
 www.dbfl.ie

DUBLIN OFFICE: Ormond House, Upper Ormond Quay, Dublin 7, Ireland.
 PHONE: +353 1 400 4000
 WATERFORD OFFICE: Unit 2, The Chandlery, 1-2 O'Connell Street, Waterford, Ireland.
 PHONE: +353 51 309 500

project ref: DE LA SALLE STRATEGIC HOUSING DEVELOPMENT BALLYFERMOT, DUBLIN 10
 drawing title: BLOCK C - BASEMENT LAYOUT

client: DWYER NOLAN DEVELOPMENTS

designed by: JMcL	author: DMS	scale: AS SHOWN	sheet size: A1
drawing no: 180189-DBFL-ZC-B1-DR-S-2900	revision: P01		